

Jukes & Co

Estate Agents



Claret Gardens

, South Norwood, SE25 6RR

£975 Per Month



GATED PARKING - A stunning 1 bedroom 1st floor flat situated in a quiet purpose built block. The flat has wood flooring throughout and benefits from a modern fitted kitchen with white goods opening onto a spacious reception room. It has a modern white fitted bathroom. Situated in a quiet road located within walking distance of Norwood Junction and Selhurst stations. Beautifully presented and ideally suited to a professional or couple.



Property Features

Entrance Hall

Entry phone, radiator, thermostat, laminate flooring, smoke alarm [not tested]

Lounge 1456'8" x 1072'10" (444 x 327)

14' 7" x 10' 9" (4.44m x 3.27m) Laminate wood flooring, double glazed window with wooden blind, spot lights, radiator,

Open plan Kitchen 1049'10" x 416'8" (320 x 127)

10' 6" x 4' 2" (3.20m x 1.27m) Laminate wood flooring, range of modern wall and base units, gas hob, oven and extractor, stainless steel sink unit - mixer tap, double glazed window with blind, spots on track

Bedroom 1348'5" x 889'1" (411 x 271)

13' 6" x 8' 11" (4.11m x 2.71m) Laminate wood flooring, double glazed window with blind, radiator

Bathroom

Lino flooring, double glazed window, low level WC, panel bath and shower, glass shower screen, wash hand basin - mixer - storage cabinets, cupboard housing boiler, extractor fan, triple mirror cabinet, part tiled walls, stainless steel heated towel rail

Area Map

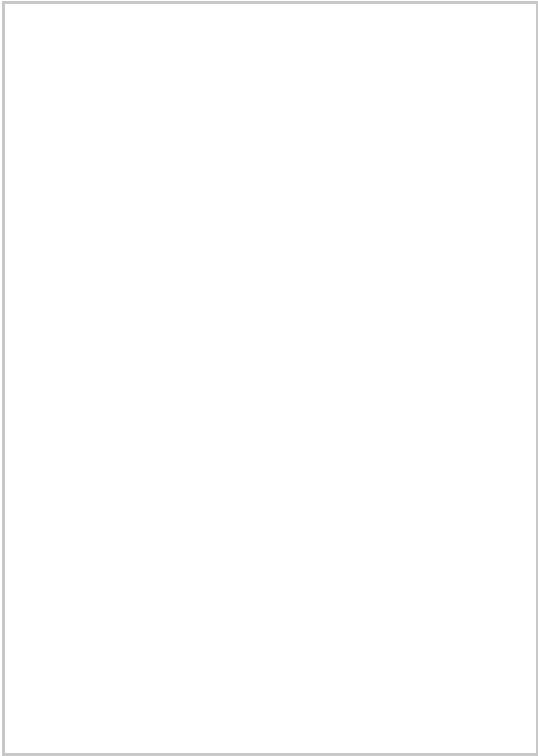

Floor Plan

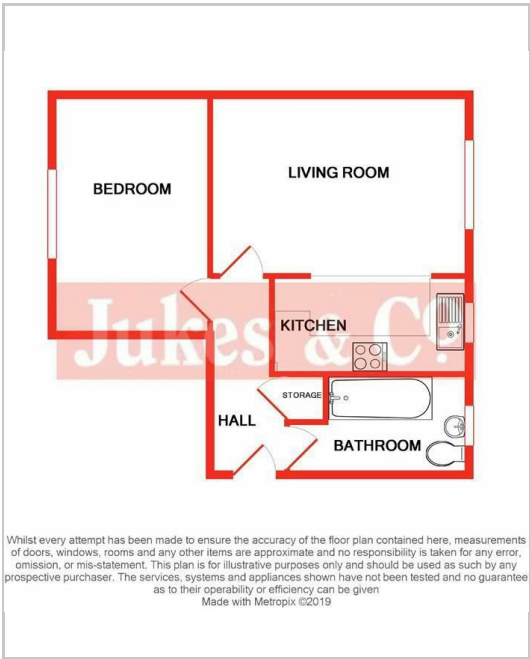

Energy Efficiency Graph

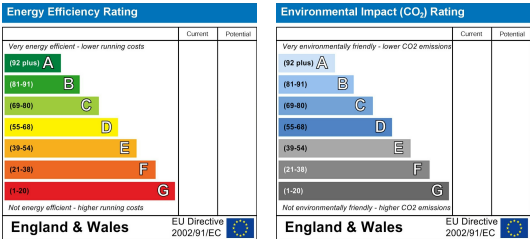

These particulars, whilst believed to be accurate are set out as a general outline only for guidance and do not constitute any part of an offer or contract. Intending purchasers should not rely on them as statements of representation of fact, but must satisfy themselves by inspection or otherwise as to their accuracy. No person in this firms employment has the authority to make or give any representation or warranty in respect of the property.